



Powrmatic 2018

Air Conditioning Product Catalogue

Effective as of 1st June 2018: Supersedes all previous issues - (e & oe)

www.powrmatic.co.uk

+44 (0) 1460 53535
info@powrmatic.co.uk





↓ **20%**
time saved on
installation

↓ **50%**
time saved on
maintenance

↓ **50%**
time saved on
cleaning

 **GOOD
DESIGN**

ALL EASY SPLIT

- | | | | | | | |
|---|--|---|--|---|---|---|
| 
Easy
Installation | 
Emergency Using | 
Mute Operation | 
Refrigerant
Leakage Detect | 
High Density
Filter | 
Louver Position
Memory | 
12 Grades Indoor
Fan Speeds |
| 
Manual ON/OFF | 
1W Standby | 
Low Ambient
Cooling | 
2-way
Draining | 
Mono & Multi
Compatible | 
5 Grades Outdoor
Fan Speeds | 
Anti-cold
Air Function |

OUTSTANDING FEATURES

All Easy Split



Easy Installation ▶

All Easy series has a strong installation plate and cupboard, which provides lots of space for pip/wiring connection, and a better wiring terminal. Reducing installation time by 20% compared with normal air conditioners.



Easy Maintenance ▶

The new structure features a universal PCB, with one PCB to suit all sizes of the All Easy series. Easily removable PCB and electrical components reduces maintenance time by 50%, saving your time and money.



Easy Clean ▶

The filters are easy to remove, and can be pulled out from the top rather than inside the panel. Simplified installation process has only 3 steps instead of the standard 9 steps, reducing cleaning time by 50%.

Direct pull out filter



Slide out chassis



AE All Easy Technical Specification

Model Number	Outdoor Unit		MSMBCU-18HRFN1-QRD0GW(B)	MSMBDU-24HRFN1-QRD0GW(B)
	Indoor Unit		MOB02-18HRFN1-QRD0GW	MOCA01-24HRFN1-QRD0GW
Electrical	V -,Hz,Ph		220-240V~ 50Hz, 1Ph	220-240V~ 50Hz, 1Ph
	Inverter Type		3D DC	3D DC
Capacity	Cooling Capacity	Btu/h Rated (min-max)	18000(6500-21100)	24000(8800-27600)
		kW Rated	5.3	7.0
	Heating Capacity	Btu/h Rated (min-max)	19000 (4900-23200)	26000 (7100-31700)
		kW Rated	4.4	5.7
Performance	SEER	W/W	6.8	6.2
	Energy Rate	Cooling	A++	A++
	SCOP Average/Warmer	W/W	4.2 / 5.4	4.0 / 5.1
	Energy Rate	Heating (Average / Warmer)	A+/A+++	A+/A+++
	Tol	°C	-15	-15
	Indoor Air Flow	Hi / Me / Lo	725 / 530 / 460	1055 / 850 / 670
	Indoor Sound Power Level	dB(A)	55	60
	Indoor Sound Pressure Level	dB(A) Hi / Med / Lo / SL	42 / 37 / 33	46 / 40 / 30
	Outdoor Sound Power Level	dB(A)	54	60
	Outdoor Sound Pressure Level	dB(A)	63	63
Dimension, Weight & Piping Sizes	Net Dimension (mm)	Indoor (W x D x H)	980 x 225 x 325	1090 x 235 x 338
		Outdoor (W x D x H)	800 x 333 x 554	845 x 363 x 702
	Packing Dimensions (mm)	Indoor (W x D x H)	1055 x 305 x 405	1165 / 420 / 315
		Outdoor (W x D x H)	920 x 390 x 615	965 x 395 x 765
	Weight (Kg)	Indoor (Net / Gross)	10.5 / 13.5	12.9 / 16.5
		Outdoor (Net / Gross)	37.2 / 40	48.5 / 51.7
Piping Size	Liquid Ø mm (inch)	Ø6.35 (1/4")	Ø9.52 (3/8")	
	Gas Ø mm (inch)	Ø12.7(1/2")	Ø15.9(5/8)	
Applicable Area	m² (min / max)		24 - 35	32 - 47



COOL COMFORT



MIDEA SMART KIT

optional extra



Mission's WiFi and Smart Kits* are designed for even more comfortable and easy operation.

- Online control
- Sleeping curve setting
- Temp zone setting
- Weekly timing

Mission Cool & Comfort



Select Eco Mode for a comfortable sleep with an intelligent 8 hour cycle that uses less energy.

ECO mode is available via the cooling mode only.

ECO MODE



The comparison between ECO and normal mode
(based on 8 hours period, inverter model)



*Test Condition: indoor/outdoor temperature 30°C, setting temperature 24°C.



SELF-DIAGNOSIS

If unusual operations or a part failure occur, the unit will shut off automatically to protect the system. It will also indicate protection or error codes on the controller which allows engineers to quickly sort issues on-site or remotely.



EASY TOUCH



MEET THE ARCTIC FOX REMOTE

Mission's sleek remote looks great and feels good. It's intuitive easy to use design gives you complete control at your fingertips.



Mission Cool & Comfort



ELEGANCE

Remote



DIAMOND CABINET



Featuring a **Screw-Free** front view cabinet design.

Rugged, durable and low maintenance.



26

MODERN

Cool, modern design with hidden LED display.

Stylish smooth curve design.



OUTSTANDING FEATURES

Each of Mission's designer features is there to make operation simple and efficient. They have been designed after extensive research and feedback from customers all over the world.



Turbo

Reach the set temperature fast by holding the ⊕ button down.



Silent

Hold the ⊖ button down to select silent mode and quiet operation.



1W Standby

Provide savings of up to 80% more energy in stand-by mode.



Self Detection

Automatic shut down if refrigerant leak is detected.



Dual Filter

HD Filter prevents dust and silver ion filter sterilizes bacterial effectively.

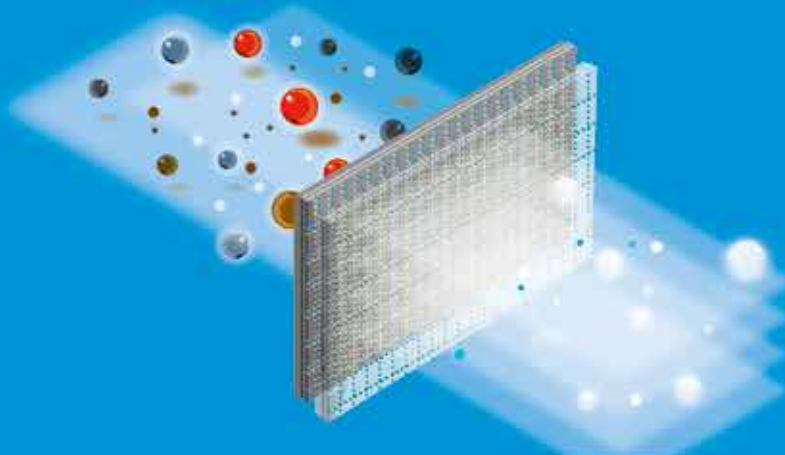

Louver Position Memory

Automatically adjusts to the position of previous operation.

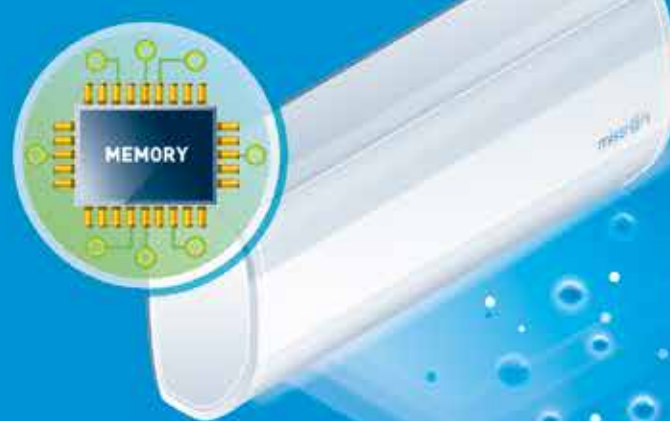

Mission Indoor Unit Technical Specification

Model Number	Outdoor Unit		MOB01-09HFN1-QRD0GW	MOB01-12HFN1-QRD0GW	MOB01-18HFN1-QRD0GW
	Indoor Unit		MSMBBU-09HRFN1-QRDOGW	MSMBBU-12HRFN1-QRDOGW	MSMBBU-18HRFN1-QRDOGW
Electrical	V -,Hz,Ph		220-240,50,1	220-240,50,1	220-240,50,1
	Inverter Type		3D DC	3D DC	3D DC
Capacity	Cooling Capacity	Btu/h Rated (min-max)	9000 (4000-11300)	12000 (4600-15400)	18000 (6500-21100)
		kW Rated	2.9	3.8	5.6
	Heating Capacity	Btu/h Rated (min-max)	10000 (3100-12800)	13000 (3700-16800)	19000 (4900-23200)
		kW Rated	2.6	2.6	4.4
Performance	SEER	W/W	6.8	7.2	6.8
	Energy Rate	Cooling	A ++	A ++	A++
	SCOP Average/Warmer	W/W	4.2 / 5.1	4.2 / 5.3	4.2 / 5.4
	Energy Rate	Heating (Average / Warmer)	A +/ A+++	A +/ A+++	A+/A+++
	Tol	°C	-15	-15	-15
	Indoor Air Flow	Hi / Me / Lo	500 / 420 / 310	419 / 458 / 266	725 / 530 / 460
	Indoor Sound Power Level	dB(A)	53	51	55
	Indoor Sound Pressure Level	dB(A) Hi / Med / Lo / SL	37 / 31 / 23 / 22	38 / 35 / 28 / 22	42 / 37 / 33 / 24
	Outdoor Sound Power Level	dB(A)	54	54	54
	Outdoor Sound Pressure Level	dB(A)	61	62	63
Dimension, Weight & Piping Sizes	Net Dimension (mm)	Indoor (W x D x H)	730 x 198 x 293	810 x 200 x 300	980 x 225 x 325
		Outdoor (W x D x H)	770 x 300 x 555	800 x 333 x 554	800 x 333 x 554
	Packing Dimensions (mm)	Indoor (W x D x H)	810 x 285 x 375	890 x 285 x 385	1055 x 305 x 405
		Outdoor (W x D x H)	900 x 345 x 585	920 x 390 x 615	920 x 390 x 615
	Weight (Kg)	Indoor (Net / Gross)	7.4 / 9.8	8.2 / 11.1	10.5 / 13.5
		Outdoor (Net / Gross)	27.1 / 29.4	29.7 / 32.4	37.2 / 40
	Piping Size	Liquid Ø mm (inch)	Ø6.35/ (1/4")	Ø6.35 (1/4")	Ø6.35 (1/4")
		Gas Ø mm (inch)	Ø9.52 (3/8")	Ø9.52 (3/8")	Ø12.7(1/2")



OUTSTANDING FEATURES

Free Match Inverter



Space-saving Installation ▶

Up to five indoor units can be connected to a single outdoor unit, reducing the number of outdoor units required. All indoor units can be individually controlled and do not need to be installed even at the same time.

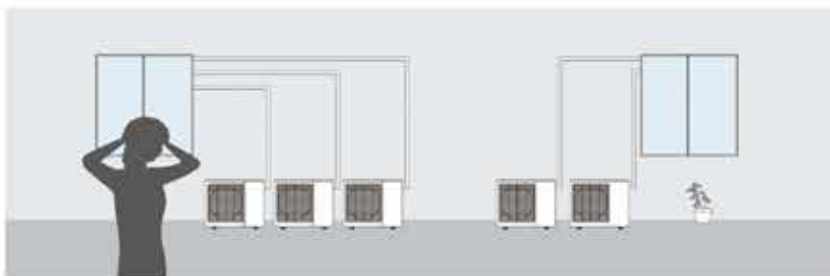

5 outdoor units



1 outdoor unit

Energy Saving ▶

Cutting-edge DC inverter of sine wave control and active PFC technology make quieter and more economical operation.

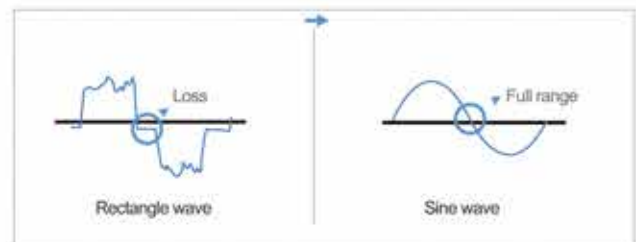
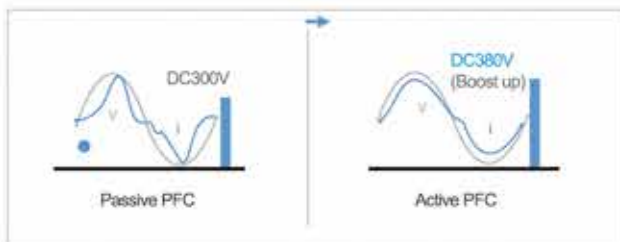

Outdoor Mission Multi Split Condensers

(09, 12 & 18 Indoor Models Only) See page 9 for indoor unit technical information

Specification		M40B - 36HFN1-Q	M50E - 42HFN1-Q
Electrical	V~,Hz,Ph	220-240,50,1	220-240,50,1
Outdoor Air Flow Volume	m³/h	5500	5500
Outdoor Sound Power Noise Level	dB(A)	68	68
Outdoor Sound Pressure Noise Level	dB(A)	63.5	62
Net Dimensions	W x D x H	946 x 410 x 810	946 x 410 x 810
Packing Dimensions	W x D x H	1090 x 500 x 875	1090 x 500 x 875
Net / Gross Weight	kg	70 / 75	76 / 81
Piping Size	mm / inch Liquid	Ø6.35 (1/4")	Ø6.35 (1/4")
	mm / inch Gas	Ø9.52 (3/8")	Ø9.52 (3/8")
Max Pipe Length For One Indoor Unit	m	15	15
Max Height Difference Between Indoor Units	m	10	10

Condenser Combinations

M40B - 36HFN1-Q		
2	3	4
9+9	9+9+9	9+9+9+9
9+12	9+9+12	9+9+9+12
9+18	9+9+18	9+9+9+18
12+12	9+12+12	9+9+12+12
12+18	9+12+18	9+9+12+18
18+18	9+18+18	9+12+12+12
	12+12+12	9+12+12+18
	12+12+18	12+12+12+12

M50E - 42HFN1-Q			
2	3	4	5
9+9	9+9+9	9+9+9+9	9+9+9+9+9
9+12	9+9+12	9+9+9+12	9+9+9+9+12
9+18	9+9+18	9+9+9+18	9+9+9+9+18
9+24	9+9+24	9+9+9+24	9+9+9+12+12
12+12	9+12+12	9+9+12+12	9+9+9+12+18
12+18	9+12+18	9+9+12+18	9+9+12+12+12
12+24	9+12+24	9+9+12+24	9+12+12+12+12
18+18	9+18+18	9+9+18+18	
18+24	12+12+12	9+12+12+12	
24+24	12+12+18	9+12+12+18	
	12+12+24	9+12+12+24	
	12+18+18	9+12+18+18	
	12+18+24	12+12+12+12	
	18+18+18	12+12+12+18	





Luna Split



Standard Features

- Refrigerant Leakage Detect
- Emergency Using Function
- Louver Position Memory
- Low Ambient Cooling
- IW Standby
- Intelligent Anti-cold Air Function
- 12 Indoor Fan Speeds
- 5 Outdoor Fan Speeds
- Sleep Mode
- Turbo Mode
- Mono & Multi Compatible
- Cold Catalyst Filter

Optional Features

- Follow Me
- Self-Cleaning
- B°C Heating
- Super Ionizer
- Plasma
- Golden Fin

OUTSTANDING FEATURES

Luna Split



Refrigerant Leakage Detect ▶

When refrigerant leakage is detected indoor, unit will show error code "EC" and stop automatically. This function can better protect compressor from being damaged by high temperature due to refrigerant leakage.

When refrigerant leakage is detected indoor, unit will show error code "EC" and stop automatically. This function can protect the compressor from being damaged by high temperature due to refrigerant leakage.



Sleep Mode ▶

The function enables the air conditioner to automatically increase cooling or decrease heating 1°C per hour for the first two hours, then holds steady for the next 5 hours, after that it will switch off. This function maintains both energy saving and comfort in night.



Follow Me ▶ (OPTIONAL EXTRA)

Temperature sensor built in the remote controller will sense its surrounding temperature. So the unit can adjust room temperature more accurately and bring you more comfort.



Super Ionizer ▶ (OPTIONAL EXTRA)

Release positive and negative ions, eliminate odor, dust, smoke and pollen particles to give you fresh and healthy air.



Luna Split Technical Specification

Model Number		Indoor Unit	LHWMS09-E	LHWMS12-E	LHWMS18-E
		Outdoor Unit	MOB-09HFN1-QRC8W	MOB-12HFN1-QRC8W	MOC-18HFN1-QRC8W
Electrical	Power Supply	V -,Hz,Ph	220-240,50,1	220-240,50,1	220-240,50,1
	Inverter Type		2D DC	2D DC	3D DC
Capacity	Cooling	Btu/h Rated(min-max)	9500 (4380-11590)	11200 (4100-13660)	17400 (6540--20010)
		kW Rated(min-max)	2.8 (1.3 - 3.4)	3.3 (1.2 - 4.0)	5.1 (1.9 - 6.9)
	Heating	Btu/h Rated(min-max)	9000 (2740--11160)	11000 (3450-13640)	18000 (4730-21240)
		kW Rated(min-max)	2.6 (0.8 - 3.4)	3.2 (1.0 - 4.0)	5.3 (1.4 - 6.2)
Performance	SEER (Average)	W/W	5.5	5.5	6.5
	Energy Rate	Cooling	A	A	A++
	SCOP (Average)	W/W	3.8	3.8	3.8
	Energy Rate	Heating	A	A	A
	Tol	°C	-15	-15	-15
	Air Flow Volume	(m³/h) Hi / Me / Lo	400 / 330 / 270	500 / 430 / 380	850 / 780 / 630
	Indoor Sound Power Level	dB(A) Hi	55	54	56
	Indoor Sound Pressure Level	dB(A) Hi / Me / Lo	37 / 31 / 24	40 / 35 / 29	41 / 35 / 28
Dimension, Weight & Piping Sizes	Net Dimensions (mm)	Indoor (W x D X H)	710 x 190 x 250	790 x 198 x 265	920 x 223 x 292
		Outdoor (W x D X H)	780 x 250 x 540	780 x 250 x 540	760 x 285 x 590
	Packing Dimensions (mm)	Indoor (W x D X H)	770 x 265 x 318	875 x 265 x 335	1015 x 295 x 368
		Outdoor (W x D X H)	910 x 335 x 585	910 x 335 x 585	887 x 355 x 645
	Weight (kg)	Indoor (Net / Gross)	6.5 / 8.5	8 / 10	11 / 13.5
		Outdoor (Net / Gross)	29.5 / 31.5	29.5 / 31.5	35 / 37
	Piping Size	Liquid Ø mm (inch)	Ø6.35 (1/4")	Ø6.35 (1/4")	Ø6.35 (1/4")
		Gas Ø mm (inch)	Ø9.52 (3/8")	Ø9.52 (3/8")	Ø12.7 (1/2")
Applicable Area (m²)		m²	13-22	16-27	25-42
Dimension, Weight & Piping Sizes	Net Dimension (mm)	Indoor (WxHxD)	710x250x190	790x265x198	918x292x223
		Outdoor (WxHxD)	670x540x250	670x540x250	760x590x285
	Net Weight (kg)	Indoor/Outdoor	7.5/26.5	9/29	11.5/39.5
	Packing Dimension (mm)	Indoor (WxHxD)	770x318x265	875x335x265	1015x368x295
		Outdoor (WxHxD)	770x585x325	770x585x325	887x645x355
	Gross Weight (kg)	Indoor/Outdoor	9.5/28.5	11/31	14.5/41
	Piping Size (mm)	Liquid	Ø 6.35 (1/4")	Ø 6.35 (1/4")	Ø 6.35 (1/4")
Gas		Ø 9.53 (3/8")	Ø 9.53 (3/8")	Ø 12.7 (1/2")	

Super Slim Round Flow Cassette

Standard Features

- | | | | | | | |
|------------------------|---------------------------|-------------------------------|---------------------------|-----------------------------|-------------------------|---------------------|
| | | | | | | |
| 360°
Air Flow Panel | Anti-cold Air
Function | Refrigerant
Leakage Detect | I-Remote | Emergency
Using Function | Reserved
On/Off Port | Error
Alarm Port |
| | | | | | | |
| Turbo Mode | Built-in
Drain Pump | Auto-Restart
Function | Louver Position
Memory | Low Ambient
Cooling | Twin
Combination | |

(OPTIONAL)

Optional Features

- | | | |
|-------------------------------|-----------|---------------------|
| | | |
| Follow Me | Ionizer | Wired
Controller |
| | | |
| Central Control
Management | Fresh Air | Healthy Filters |

Super Slim Design



OUTSTANDING FEATURES

Super Slim Round Flow Cassette



360° Air Flow Panel ▶

With the 360° air flow panel, the air can be distributed to every corner of the room.

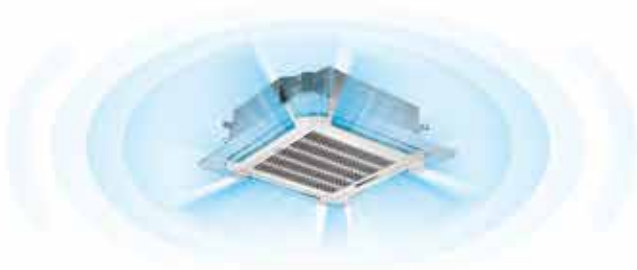

360° Air Flow Panel

Reserved ON-OFF and Alarm Ports ▶

ON-OFF Switch: With the reserved ports, a remote switch can be easily connected to a real external remote control.

Alarm Port: The built-in PCB can output alarm signal, which makes setting up an external alarm light or vibration gauge possible.



Independent Vane Control ▶

The direction of each vane can be set independently by using the wired controller.



Twin Combination ▶ (CTCS24 & CTC30 Only)

The units can be installed as twin systems: one outdoor unit can be connected with two same indoor units. The indoor units can be combined in any of the different available ratings.



Super Slim Round Flow Cassette Technical Specification

Model Number		Indoor Unit	PMC SSRFC36	PMC SSRFC48
		Outdoor Unit	MOYU-36HDN1-QRDO	MOEU-48HDN1-QRDO
Electrical	Power Supply	V~,Hz,Ph	220 - 240, 50, 1	220 - 240, 50, 1
	Inverter Type		3D DC	3D DC
Capacity	Cooling Capacity	Btu/h Rated(min-max)	36000 (9550 - 44300)	47000 (13600 - 55800)
		kW Rated(min-max)	10.5 (2.8 - 13.0)	13.8 (4.2 - 18.5)
	Heating Capacity	Btu/h Rated(min-max)	38000 (9210 - 55200)	53000 (14300 63000)
		kW Rated(min-max)	11.7 (2.7 - 16.1)	15.5 (4.2 - 18.5)
Performance	SEER (average)	W/W	5.6	5.6
	Energy Rate	Cooling	A++	A
	SCOP (average)	W/W	4.0	4.0
	Energy Rate	Heating	A+	A+
	ToI	°C	-15	-15
	Air Flow Volume	m ³ /h Hi / Me / Lo	1900 / 1750 / 1460	1850 / 1600 / 1400
	Indoor Sound Power Noise Level	dB(A) Hi	65	65
	Indoor Sound Pressure Noise Level	dB(A) Hi / Me / Lo	56 / 52 / 48	53 / 49 / 45
	Outdoor Sound Power Noise Level	dB(A)	62	62
	Outdoor Sound Pressure Noise Level	dB(A)	71	71
Dimension, Weight & Piping Sizes	Net Dimension (mm)	Body (W x D x H)	840 x 840 x 245	840 x 840 x 287
		Panel (W x D x H)	950 x 950 x 55	950 x 950 x 55
	Packing Dimensions	Body (W x D x H)	900 x 900 x 265	900 x 900 x 292
		Panel (W x D x H)	1035 x 1035 x 90	1035 x 1035 x 90
	Weight (kg)	Body (Net / Gross)	26.5 / 30.5	28 / 32.1
		Panel (Net / Gross)	5/8	5/8
	Piping Size (mm)	Liquid Ø mm (inch)	9.5 (3/8")	9.5 (3/8")
		Gas Ø mm (inch)	15.9 (5/8')	15.9 (5/8')
Applicable Area	m ²	42-70	59-93	

All indoor units needs a single phase supply + all Outdoor units needs a separate supply according to Specs. All units would need a communications cable between indoor and outdoor 3-core 0.75mm to 1.0mm.

The power supply requirements are as follows:

- SSRFC-24 Indoor requires Single phase supply of not more than 5 A - 220 V/50Hz
- SSRFC-30 Indoor requires Single phase supply of not more than 5 A - 220 V/50Hz
- SSRFC-36 Indoor requires single Phase supply of not more than 5 A - 220 V/50Hz
- SSRFC-48 Indoor requires single phase supply of not more than 5 A - 220 V/50Hz
- SSRFC-60 Indoor requires single phase supply of not more than 5 A - 220 V/50Hz

The power supply requirements are as follows:

- MOU-24HRFN1 Outdoor Unit requires Single phase not more than 15 A - 220 V/50Hz
- MOU-30HRFN1 Outdoor Unit requires single phase not more than 20 A - 220 V/50 Hz
- MOU-36HRFN1 Outdoor unit requires single phase not more than 25 A - 220 V/50Hz
- MOU-48HRFN1 Outdoor Unit requires single phase not more than 30A - 220V/50Hz
- MOU-60HRFN1 Outdoor Unit requires 3 Phase Supply not more than 20A-380-415V/50Hz



Technical & Installation Guide

Model	Fitting	Cooling Capacity		Heating Capacity		Sound Power Level dB(A) Hi		Interconnecting Cable	MCB/ Phase	Mains power to	Built in Pump	Pipe size (") inches	Max. Pipe Run m	Refrigerant Charge over 5 mtrs/ Mtr	Max. Height Diff. m
		kW	kW	Indoor	Outdoor	Indoor	Outdoor								
ALL EASY HIGH WALL SPLIT															
PMC AE18	Wall Mounted	5.3	4.4	55	60	5 Core 1.5mm	10A/1ph	Outdoor	N/A	1/4 + 1/2	25	20g/Mtr	10m		
PMC AE24	Wall Mounted	7.0	5.7	54	60	5 Core 1.5mm	10A/1ph	Outdoor	N/A	3/8 + 5/8	25	20g/Mtr	10m		
MISSION SERIES ERP															
MISSION09-E	Wall Mounted	2.6	2.6	53	61	5 Core 1.5mm	10A/1ph	Outdoor	N/A	1/4 + 3/8	20	20g/Mtr	10m		
MISSION12-E	Wall Mounted	3.5	2.6	51	62	5 Core 1.5mm	10A/1ph	Outdoor	N/A	1/4 + 3/8	20	20g/Mtr	10m		
MISSION18-E	Wall Mounted	5.3	4.4	55	63	5 Core 1.5mm	10A/1ph	Outdoor	N/A	1/4 + 1/2	25	20g/Mtr	10m		
LUNA HIGH WALL ERP															
LHWM509-E	Wall Mounted	2.8	2.6	55	63	5 Core 1.5mm	8A/1ph	Outdoor	N/A	1/4 + 3/8	20	20g/Mtr	8m		
LHWM512-E	Wall Mounted	3.3	3.2	54	63	5 Core 1.5mm	10A/1ph	Outdoor	N/A	1/4 + 3/8	20	20g/Mtr	8m		
LHWM518-E	Wall Mounted	5.1	5.3	56	65	5 Core 1.5mm	15A/1ph	Outdoor	N/A	1/4 + 1/2	25	20g/Mtr	10m		
SUPER SLIM CASSETTE 4-Way 360 Round flow - ERP															
SSRFC36	Ceiling Cassette	10.5	11.7	64	N/A	3 core 1.0mm	25A/1ph	In and Out	Included	3/8+5/8	30	40g/Mtr	15m		
SSRFC48	Ceiling Cassette	13.8	15.5	65	N/A	3 core 1.0mm	32A/1ph	In and Out	Included	3/8+5/8	50	40g/Mtr	15m		

The New Vision Range

The new Powrmatic Vision range is a twin duct low level PTAC air conditioner & heat pump and removes the need for an outdoor unit. The Vision requires no external condenser, saving you costs on installation and improving the aesthetic appearance of your building. The 160mm twin duct, and a 14mm condensate pipe hole reduces the outdoor impact of air conditioning systems and seamlessly integrates into any exterior building design.

To assist hoteliers with air conditioning control, Powrmatic have introduced WiFi Control which lets you control multiple units from your smart-phone device or tablet via your local WiFi network. The Vision inverter model has a impressive 27dB(A) and with a depth of just 17cm, the Vision is by far the slimmest unit in this category of product.

The Vision features clean lines in a contemporary, eye-catching style that will complement any décor with and no sight of an outdoor condenser it makes the unit ideal for hotel rooms, restaurants and many other hospitality applications.

Packaged Technology

The need for air conditioning today is present winter and summer. All too often this means installing unsightly condensing units on the exterior of buildings.

The Powrmatic Vision is a packaged solution which removes the need for an outdoor unit, and incorporates state of the art "monobloc" technology. The Vision also does not require a F-Gas certified engineer to install saving you as significant amount on installation costs.

Standard Models

(all models are WiFi enabled)

- Vision 2.3 DW
- Vision 3.1 DW
- Vision VertiCool
- Vision 3.1 DW/H (Low Temperature Resistance Heater)
- Vision LTHW (Fan coil model)
- Vision DWM (Marinised model. Special order only-MOQ 50 Units)

Installer Benefits

- No external condenser required
- Quick and simple installation
- No re-decoration costs
- Supplied with 13A standard BS plug top
- No requirement for internal and external pipework
- Easy maintenance access
- No F-Gas certificate to install

New Model & Design Available

Powrmatic have now introduced the Vision VertiCool upright standing model to give a heating and cooling option for those rooms with limited horizontal high or low wall space.

The standard horizontal Vision has also been re-designed with a more curved finish and full metal body to improve its visual appearance and performance longevity.



TYPICAL APPLICATIONS

- Hotels
- Offices
- Restaurants
- Garden buildings
- Portable buildings
- Apartments
- Domestic houses
- Listed buildings

No Outdoor Condenser

The Vision requires no external condenser, saving you costs on installation and improving the aesthetic appearance of your building. The 160mm twin duct, and a 14mm condensate pipe hole reduces the outdoor impact of air conditioning systems and seamlessly integrates into any exterior building design. As a result, there is minimum impact on the building's exterior and complies with many regulations on listed buildings.

Heating Or Cooling Options

Each Vision model has the ability to heat and cool your building from -6°C to 31°C

The Vision DW/H has lowering performances in heating when outdoor temperature is falling where the heat pump is integrated (and not replaced) by a 1 kW electrical resistance that intervenes automatically when outdoor temperature become extremely low.

WiFi Enabled Control

The easy to use app displays current temperature settings and allows the user to change temperature, fan speed, and air flow direction from anywhere at a touch of a button.

In applications such as hotel buildings, the reception desk can activate, control, and deactivate each unit in every room depending on the occupancy. They can warm up or cool down the room before hotel guests arrive, and ensure the units are switched off when the room is unoccupied saving valuable energy consumption.



Retro- Fit Installation

The Vision can be retrofitted into many applications where there is a current A/C system. With no requirement for an external condenser, and extensive pipework, upgrading an existing split air conditioning system is simple.

Application Flexibility

The installation is easy due to the standard core drill bit required to make the 160mm holes. The Vision can be installed on any external wall, either at a low or high position. All that is required for the installation (template, supporting bracket, outdoor grills, insulating wall pipes) is contained in the carton box ready to install. All that is required to be provided by the installer is the drilling machine and core bit.

PRODUCT BENEFITS

- No requirement for an external condenser
- Ability to both heat and cool
- WiFi enabled control
- Touchscreen & remote control
- 16°C to 31°C temperature range
- Programmable timer control

Your Space. Your Choice.

Vision (2018 New Design)

The 2018 Vision range has been redesigned with a smooth curved shell and now incorporates a full metal body to give it a more solid and consistent performance eliminating all plastic parts in its construction.

The units employs new techniques and technology to precisely follow the curves of the design, all the way to the elegantly rounded corners. The smooth, polished white PPC finish allows the unit to fully complement any room decor and design.

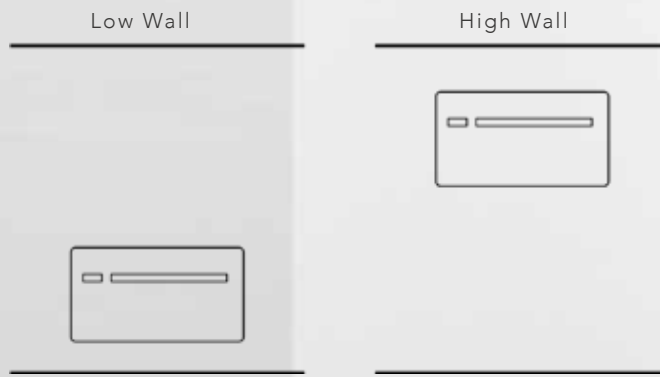

**NEW
DESIGN**

Dimensions

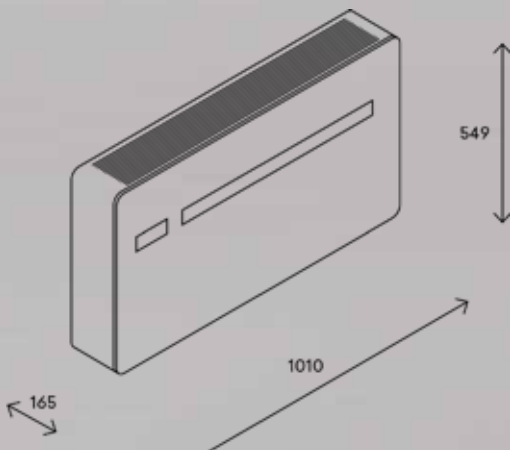

Vision VertiCool

The **Vision VertiCool** is the latest in the range with a new and stylish vertical approach that can be installed in areas between windows, or in room corners making it the perfect alternative for those rooms where space and access to an external low or high wall is limited.

The VertiCool is installed the same as the standard unit with an impressive depth of only 185mm allow it to integrate seamlessly into any room.

**NEW
PRODUCT**



Vertical

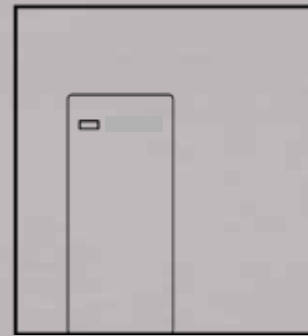

Dimensions

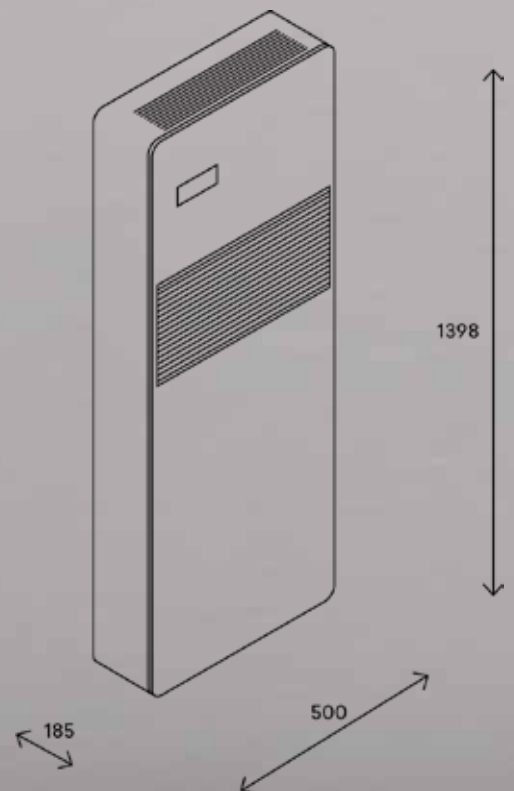

Additional Heat Model (DW/H)

As all heat pumps have lowering performances in heating when outdoor temperature is falling, sometimes their request is to have a consistent heating capacity with extremely low outdoor temperatures.

The Vision DW/H integrates (not replaces) the heat pump with an additional 1 kW electrical heater that intervenes automatically when outdoor temperatures become extremely low.

Because of this the DW/H can deliver a heating capacity of at least 2 kW even with outdoor temperatures down to -7°C , with an energy absorption of 1 kW that is extremely low and fully compatible with standard domestic power supplies.

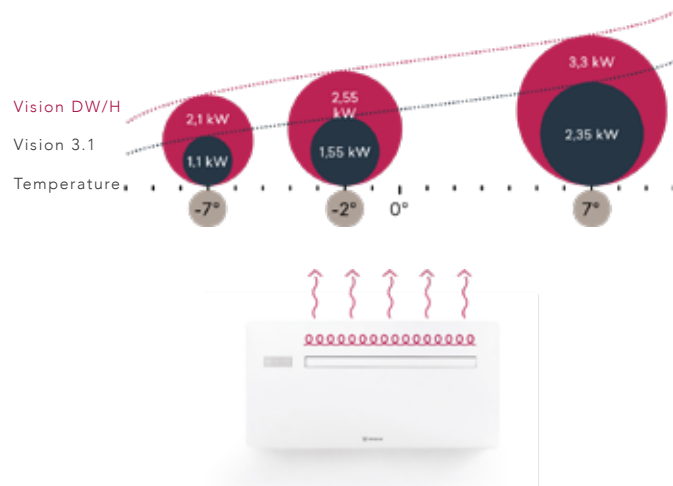

Fan Coil Model (LHTW)

The Vision LHTW one single body integrates both an air conditioning system for summer cooling and winter heating, and a fancoil for winter heating with low temperature hot water systems.

In winter time, heating is supplied by the heat pump functioning mode; when outdoor temperatures decrease, the LHTW automatically integrates the heat pump functioning with a fancoil to maintain the set temperature. In cases where external temperatures become particularly low, heating with the fancoil only can be set.

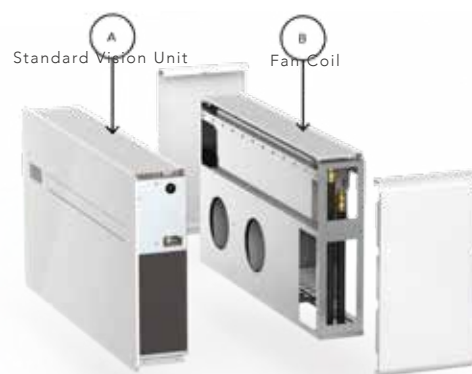

Vision DWM Marinised Model (minimum order quantity of 50)

All components near sea are exposed to corrosive, salty air and must meet special structural requirements. The Vision DWM is a full protected air conditioning unit utilising a copper/copper condenser and evaporator coil, stainless steel chassis, cabinet and assembly components, to, prolong the life of the unit in harsh saline conditions make the Marinised Vision perfect for coastal and high ambient tropical conditioners.



SPECIAL ORDER ONLY



Side Discharge Option (Left or right side)

Air conditioning without outdoor condensing unit are always installed on a perimeter wall, so to exchange air with the outside. Sometimes this is not possible, as the "outside" is lateral with respect to the wall hosting the unit. With this new kit, to be built into the wall, the airflow is deviated laterally: therefore it is possible to install the Vision on the wall with side air exit. This allows many new and unexpected possibilities to install the Vision Unit.



Vision Technical Specification

Technical Data	U.M	2.3 DW	3.1 DW	3.1 VertiCool	3.1 DW/H	LTHW
Cooling Capacity	kW	2.04	2.35	2.35	2.35	Refer To Model
Cooling Capacity - Dual Power Max / Min	kW	2.6 / 0.8	3.1 / 0.9	3.1 / 0.9	3.1 / 0.9	
Heating Capacity	kW	2.10	2.36	2.36	2.36	
Heating Capacity - Dual Power Max / Min	kW	2.64 / 0.7	3.05 / 0.8	3.05 / 0.8	3.05 / 0.8	
Power Input In Cooling	W	630	730	855	730	
Power Input In Heating	W	638	720	750	720	
Power Of Electric Heater	kW	N/A			1.00	N/A
Heating Capacity Fan Coil (70°C)	kW	N/A				4.23
Water Flow Rate	L/h	N/A				364
Water Pressure Loss (70°C)	KPa	N/A				10
Dehumidification Capacity	l/h	0.8	0.9	0.9	0.9	Refer To Model
Power Supply Voltage	V-F-Hz	230/1/50				
EER	W/W	3.24	3.22	2.75	3.22	
COP	W/W	3.29	3.28	3.15	3.28	
Energy Efficiency Ratio When Cooling		A+	A+	A	A+	
Energy Efficiency Ratio When Heating		A	A	A	A	
Dimensions (W x H x D)	mm	1030 x 555 x 165	1030 x 555 x 165	500 x 1398 x 185	1030 x 555 x 165	1030 x 555 x 143
Weight	Kg	48.5	48.5	53	48.5	Refer To Model
Noise Level (Min / Max)	dB(A)	26 / 39	27 / 41	27 / 41	27 / 41	
Wall Hole Diameter / Condensate Drain	mm	162 / 14				
Refrigerant Gas		R410A				

Condensate Nebuliser

The **condensate nebuliser** can be supplied to replace the external condensate pipe.

The nebuliser is fitted underneath the unit and effectively heats the condensate air, turns it to vapour and then in turn it is expelled by the internal nebuliser fan.

Technical Data	U.M	Condensate Nebuliser
Dimensions (W x H x D)	mm	378 x 232 x 140
Weight	kg	4.8
Capacity	L/h	2
Inlet (Top Cover)	mm	16
Outlet (Back Side)	mm	80
Consumption (max)	W	220
Power	V	230

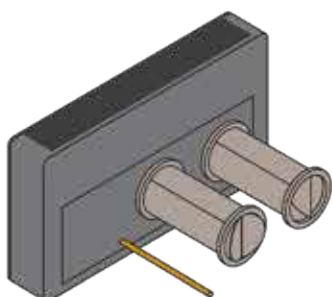

Standard External Condensate Pipe

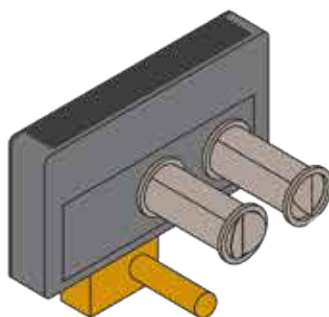

Fitted Nebuliser Condensate Pipe

Accessories / Spares

Description
Vision Wired Controller
Vision Remote Control (provided with unit)
Condensate Nebuliser
External Grilles (pair)
Side Discharge (left or right side)



Wired Controller



Remote Controller



Condensate Nebuliser



External Grilles

Coolair CPL1100 Evaporative Cooler

Take the natural approach to cooling. Seeley International's Coolair range of evaporative coolers delivers lots of cool, 100% fresh air, at much lower costs than refrigerated cooling methods.

Coolair units feature advanced technology and a range of unique and clever design features that combine to achieve the highest cooling performance of any similar air conditioner.

Evaporative cooling is fast becoming the only viable option for cooling large areas. A Coolair system uses up to 80% less energy than a refrigerated cooling system. Doors and windows can be left open, with absolutely no loss of cooling efficiency.



Coolair Benefits

- Up to 90% cheaper to run compared to reverse cycle cooling
- Whisper-quiet cooling
- Low maintenance costs
- Delivers fresh, filtered, healthy outside air
- Low CO2 emissions for the environment
- Superb whole-of-home cooling

Applications

- Warehouses
- Repair/Maintenance areas
- Sports centres
- Educational Buildings
- Manufacturing plants
- Storage areas
- Laundries/dry cleaners
- Commercial kitchens
- Agricultural facilities



High Wall & Cassettes

Part Number	Description	Used On
ACPIPEKIT001	5 mtr pipe kit , Specification 6.35mm & 12.7mm (1/4" & 1/2")	LHWMS18 / MISSION18-E-4.0 / PMC AE18
ACPIPEKIT002	5 mtr pipe kit , Specification 6.35mm & 9.52mm (1/4" & 3/8")	LHWMS09 / LHWMS12 / MISSION09-E-4.0 /
ACPIPEKIT003	5 mtr pipe kit , Specification 9.52mm & 16.0mm (3/8" & 5/8")	LHWMS24 / PMC AE24
MISSION WIFI	Mission Unit WiFi Control	Mission Units Only
KJR-135A	Central Control Touch Panel (Single units only)*	SSRFC / ALL AE MODELS units only
KJR-90A	Universal Remote Control (Up to 4 units)*	SSRFC / ALL AE MODELS units only
CCM03	Central Controller (Up to 64 units)*	SSRFC / ALL AE MODELS units only
CCM09	Central Controller with weekly schedule timer (Up to 64 units)*	SSRFC / ALL AE MODELS units only

Notes:

- * KJR 135A Wired Remote Control c/w Touch Panel Display is compatible with the following models only: SSRFC24, SSRFC36, SSRFC48
- * KJR 90A Wired Remote Control is compatible for all units except the Luna range
- * CCM03 Wired Central Control is compatible for all units except the Luna range. The CCM03 can also be connected to a BMS system.
- * CCM09 Central Controller with weekly schedule timer cannot be connected to a BMS system



KJR-135A

KJR-90A

CCM03

CCM09

Refnet

Pipe Kits

Coolair Evaporative Cooler Accessories



Part Number
IWC10 Wall Controller
SmartHub Control
Upgrade Kit – TBA550 Drain Valve & Salinity Probe
Upgrade Kit – Backdraft Dampers
Roof Vent (Painted to RAL Colour, Minimum 50 Pieces)

Your Area Sales Managers

Paul Greenough

Alr Conditioning Product Manager

+(353) 0866 040 613

paulgreenough@powrmatic.co.uk

Darryl Redfearn

Dedicated Alr Conditioning Sales - Northern Region

07531 342 154

darrylredfearn@powrmatic.co.uk

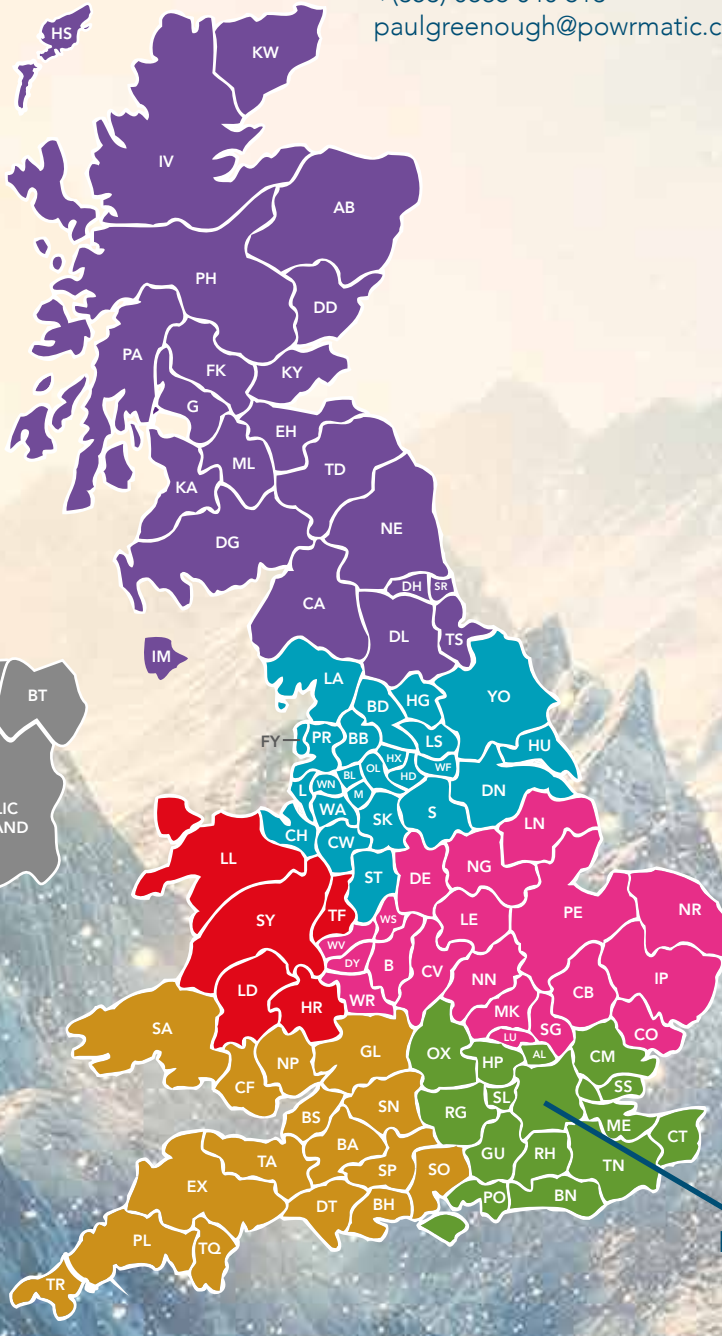

Tony Delaney - Ireland

+(353) 0866 040 613

tonydelaney@powrmaticireland.com

Geoff Stevenson - Scotland & North East

07971 079 711

geoffstevenson@powrmatic.co.uk

Alan Yates - North West

07812 095 964

alanyates@powrmatic.co.uk

Dave Greaves - Mid Wales

07766 061 514

davegreaves@powrmatic.co.uk

Martin Arden - Midlands

07971 079 717

martinarden@powrmatic.co.uk

Chris Spencer - South East

07525 912 220

chrisspencer@powrmatic.co.uk

Chris Warry - South West

07971 079 724

chriswarry@powrmatic.co.uk

Head Office

Powrmatic Limited
Hort Bridge
Ilminster
Somerset
TA19 9PS

tel: +44 (0) 1460 53535
fax: +44 (0) 1460 52341
e-mail: info@powrmatic.co.uk
web: www.powrmatic.co.uk



#keepingthenationwarm



Powrmatic pursues a policy of continues improvement in both design and performance of its products and therefore reserves the right to change, amend or vary specifications without notice. Whilst the details contained herein are believed to be correct they do not form the basis of any contract and interested parties should contact the company to confirm whether any material alterations have been made since publication of this brochure.